

MARCELO

- 1ST FLOOR
- 1ST, 2ND & 3RD FLOORS
- 2ND & 3RD FLOORS
- 2ND, 3RD & 4TH FLOORS
- ALL FLOORS

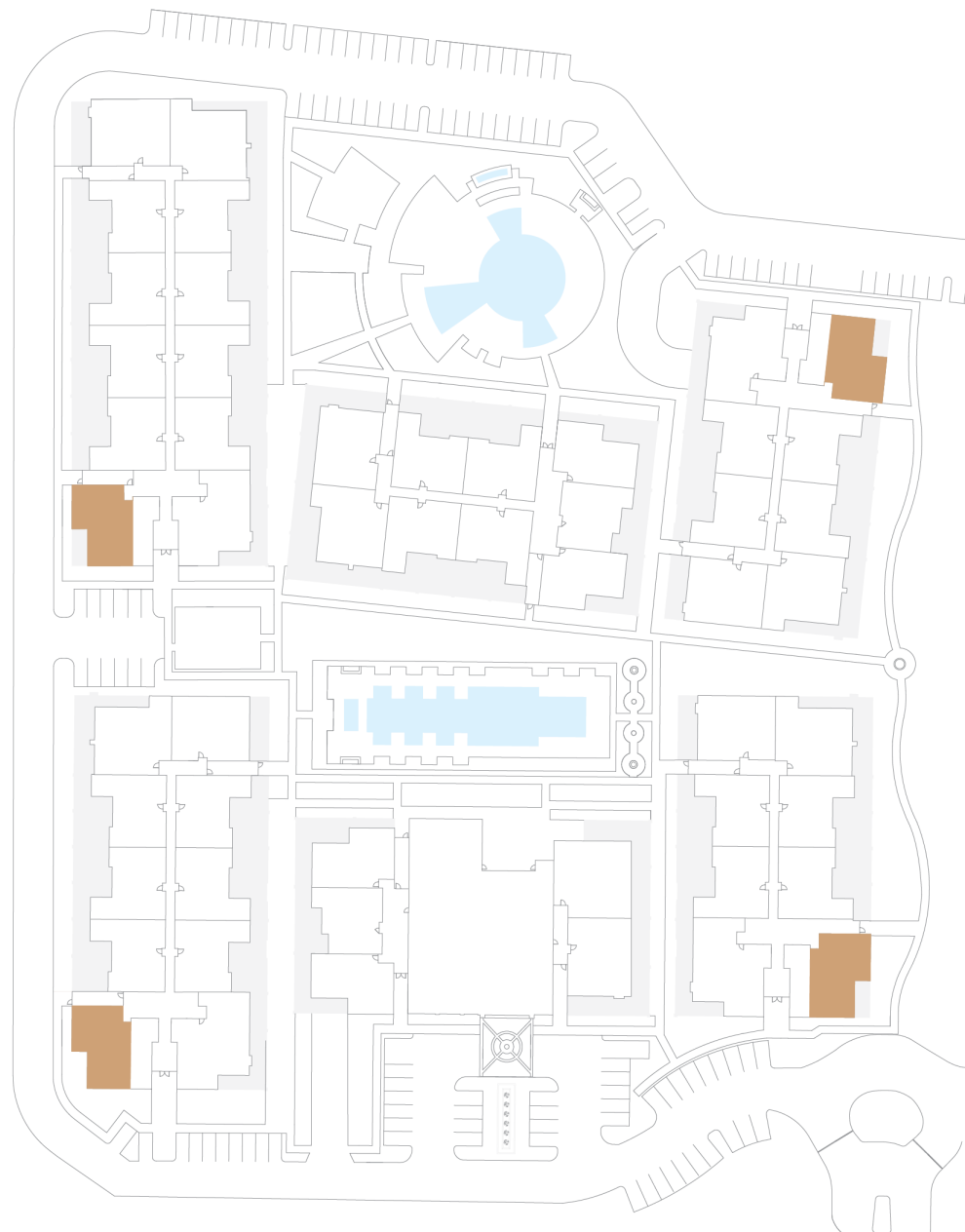

DEER VALLEY DRIVE

STATESMAN

MARCELO

THE *Luxe*

■ CONCRETE COLUMN



MARCELO

DUAL MASTERS
 BEDROOM #3
 BATHROOM #3
 POWDER ROOM
 LAUNDRY AND MECHANICAL
 DOUBLE PATIO

TOTAL LIVING AREA 2,177 SQ FT
 TOTAL PATIO 376 SQ FT

DETAILS: SMART HOME TECHNOLOGY. 10' CEILINGS IN LIVING ROOM AND KITCHEN. GAS FIREPLACE. BOSCH APPLIANCES. DOUBLE BUILT-IN OVENS. NATURAL GAS 5-BURNER COOKTOP. UPGRADED QUARTZ KITCHEN COUNTERTOPS AND RAISED PANEL CABINETS. DOUBLE MASTER WITH LARGE WALK-IN CLOSET. KOHLER / DELTA BATHROOM FINISHES WITH COMFORT HEIGHT TOILETS. LARGE LAUNDRY ROOM. SOFT WATER. INDOOR / OUTDOOR LIVING, EXPANSIVE PATIO AND DUAL SLIDING GLASS DOORS.

UNCOMPROMISING OPTIONS:

- A** OUTDOOR GRILL
- B** WINE COOLER
- C** FLEX SPACE WITH BARN DOORS
- D** WINE BAR
- E** SLIDING GLASS PATIO DOOR
- F** BARN DOORS TO ENSUITE MASTER BATH
- G** SHOWER IN LIEU OF TUB / SHOWER COMBO
- H** CUSTOMIZABLE COUNTERTOPS AND SHELVING