

VALENTINO

- 1ST, 2ND & 3RD FLOORS
- 2ND & 3RD FLOORS
- 2ND, 3RD & 4TH FLOORS
- ALL FLOORS

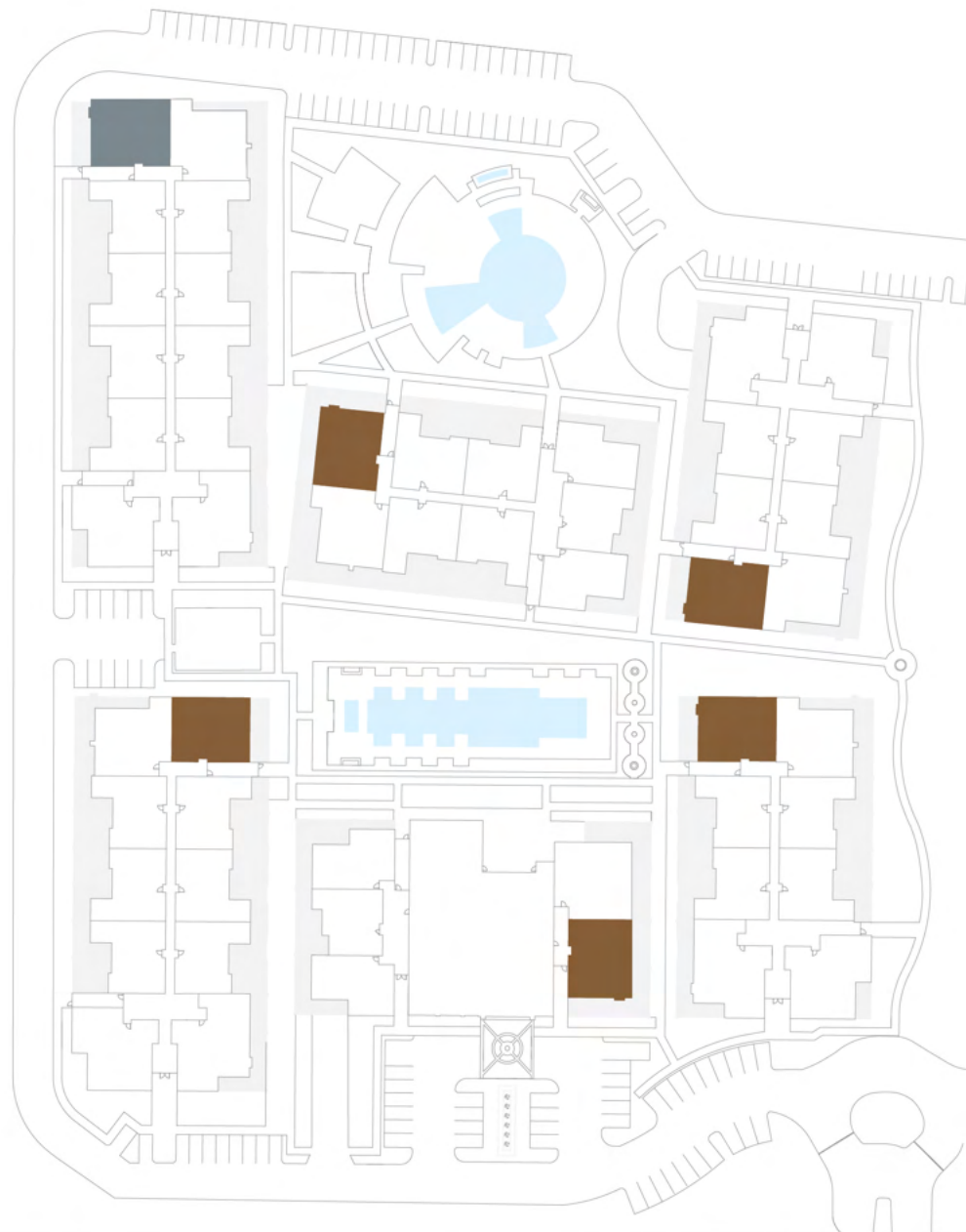

DEER VALLEY DRIVE

STATESMAN

VALENTINO

THE *Luxe*

CONCRETE COLUMN

EXTENDED PATIO ON FIRST FLOOR UNITS



VALENTINO

DUAL MASTERS
POWDER ROOM
LAUNDRY AND MECHANICAL

TOTAL LIVING AREA 2,014 SQ FT
TOTAL PATIO + BALCONY 540 SQ FT
EXTENDED PATIO 662 SQ FT

DETAILS: SMART HOME TECHNOLOGY. 10' CEILINGS IN KITCHEN AND LIVING ROOM. 11' CEILINGS IN PENTHOUSE KITCHEN AND LIVING ROOM IN ADDITION TO EXPANDED TRANSOM WINDOWS. GAS FIREPLACE. BOSCH APPLIANCES. DOUBLE BUILT-IN OVENS. NATURAL GAS 5-BURNER COOKTOP. UPGRADED QUARTZ KITCHEN COUNTERTOPS AND RAISED PANEL CABINETS. DOUBLE MASTER WITH LARGE WALK-IN CLOSET. KOHLER AND DELTA BATHROOM FINISHES WITH COMFORT HEIGHT TOILETS. LARGE LAUNDRY ROOM. SOFT WATER. INDOOR / OUTDOOR LIVING, EXPANSIVE PATIO AND DUAL SLIDING GLASS DOORS.

UNCOMPROMISING OPTIONS:

- A** OUTDOOR GRILL
- B** WINE COOLER
- C** KITCHEN COUNTER EXTENSION
- D** FLEX SPACE / BED #3 WITH BARN DOORS + CLOSET
- E** GLASS WALL
- F** SHOWER IN LIEU OF TUB / SHOWER COMBO
- G** CUSTOMIZABLE COUNTERTOPS AND SHELVING